

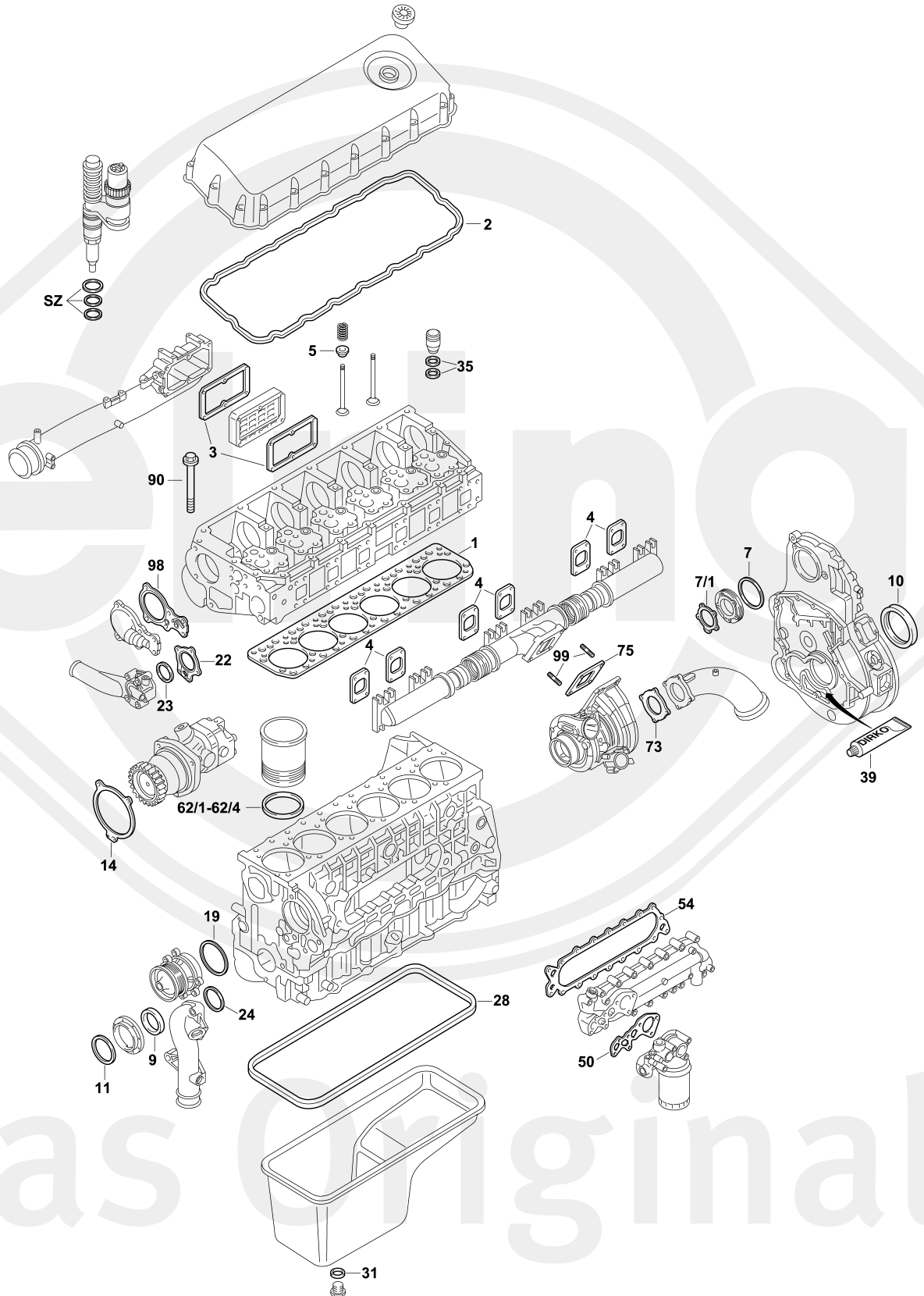

Das Original

Iveco

Cursor 8





F2BE 0642 A/B/C/D/F
 F2BE 0681 A/C/D
 F2BE 0682 A/B/C/D/F
 F2BE 3681 A/C



ES ⊕	689.920	1x	500 395 171	–	F2BE 0642 A/B/C/D/F F2BE 0681 A/C/D F2BE 0682 A/B/C/D/F
ES ⊕	745.610	1x	299 6171	–	F2BE 3681 A/B/C
S ⊕*	648.670	1x	500 054 747	–	F2BE 0642 A/B/C/D/F F2BE 0681 A/B/C/D F2BE 0682 A/B/C/D/F
S ⊕*	649.710	1x	500 054 722	–	F2BE 3681 A/B/C
SZ	660.480	6x	504 164 259	–	–
TLS	715.470	1x	–	–	–
1	538.970	1x	500 382 172	∅ 127,5 mm $\frac{\pm}{\mu}$ 1,50 mm	–
2	569.400	1x	9944 6692	–	–
3	584.800	2x	504 026 624	–	–
4	122.130	6x	504 154 202	–	–
5	143.930	12x	4010 1573	8x12/15,2x9,5 FPM	–
7		1x	1729 2381	129,8x2,53 FPM RD	–
7/1		1x	504 045 791	–	–
9	698.340	1x	9944 7290	88x123x15 KS RD FPM	–
10	381.260	1x	9944 7291	112x147x13 KS LD FPM	–
11		1x	1729 2281	126,59x3,53 FPM RD	–
14		1x	504 045 787	–	–
19		1x	1729 1781	110,72x3,53 FPM RD	–
22	–	1x	504 045 785	–	–
23	754.854	1x	9845 1661	6,35x53,1x67,58 PTFE	–
24		1x	1729 0081	56,74x3,53 FPM RD	–
28	569.530	1x	9944 3902	–	–
31	128.503	1x	1650 8460	22x27x1,5 CU A	–
35		12x	1727 8881	23,5x1,7 FPM RD	–
39	036.164	1x	–	70 ml	 Dirko™ HT
50	588.580	1x	504 013 562	–	–
54	588.500	1x	504 045 796	–	–
62/1	–	6x	984 56128	$\frac{\pm}{\mu}$ 0,08 mm	–
62/2	–	6x	984 56129	$\frac{\pm}{\mu}$ 0,10 mm	–



F2BE 0642 A/B/C/D/F
 F2BE 0681 A/C/D
 F2BE 0682 A/B/C/D/F
 F2BE 3681 A/C



62/3	-	6x	984 56130	$\pm 0,12 \text{ mm}$	-
62/4	-	6x	500 350 504	$\pm 0,14 \text{ mm}$	-
73	-	1x	500 301 732	-	->  17841
75	588.490	1x	9845 1118	-	-
90	-	26x	500 354 580	M16x2x170	-
98		1x	9945 0932	-	-
99	372.170	2x	1673 1370	M10x30	-